



HELIROMA

HELIROMA RED FIRE
Fire Protection networks

WHO WE ARE:

- Located: Albergaria-a-Velha - Aveiro;
- Production: Plastic piping systems for: hot and cold water and climatization applications
- Main Iberian manufacturer of the 4 most used water conduction systems:
 - **PP-R** and **PP-RCT**
 - **PERT-AL-PERT**
 - **PE-Xa**
 - **PE-RT**
- Wide range of products - Ø 20mm to 400mm;
- Company at the forefront of technologies and innovation.



 **HELIROMA**

HELIROMA RED FIRE

FM
APPROVED

AENOR

Producto
Certificado

HELIROMA's new product: RED FIRE

PP-R 100 & Fiberglass System

Firefighting installations

New market segment



RED FIRE PIPE:

Characteristics:

- **Diameter:** Ø 20-125 mm (SDR11*)
- **Color:** Red
- **Raw material:** PP-R 100
- **3 Layers:** With flame retardant additives
- **Fire reaction classification:** B-s1,d0
- **Welding:** Thermofusion socket union
- **Operation conditions:** 12,5 bar | 20°C
- **Expected durability:** >50 years

*Ø 20-25 (SDR 7,4)



RED FIRE FITTINGS

Characteristics:

- **Diameter:** Ø 20-125 mm
- **Raw material:** PP-R and PP-R 125
- **With flame retardant additives**
- **Fire reaction classification:** B-s1,d0
- **Welding:** Thermofusion socket union

STANDARDS

ISO15874

DIN 8078

EN 671

DIN 8077

EN 12845

EN 13501



FIRE REACTION CLASSIFICATION

RED FIRE

EN 13501-1

Fire reaction class

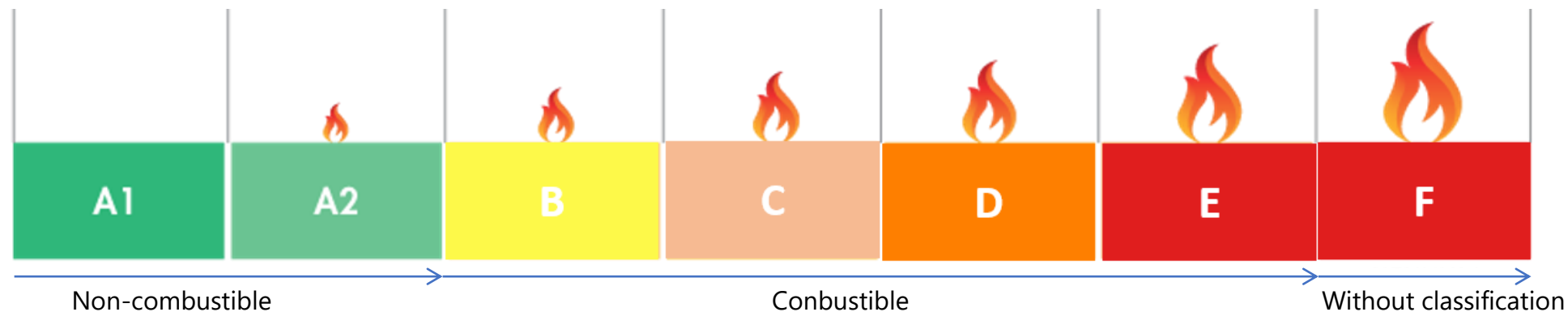

FIRE REACTION CLASSIFICATION RED FIRE

Complementary classification

- ✓ **SMOKE** production / emission: s1 to s3 – absent / abundant



- ✓ **DROPS** or **FLAME PARTICLES**: d0 to d2 – absent / abundant

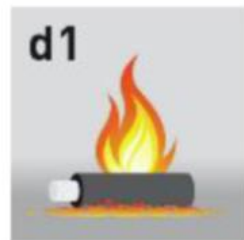

FIRE REACTION CLASSIFICATION

RED FIRE

B-s1, d0

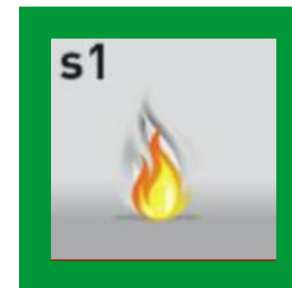

APPLICATIONS

RED FIRE

- The **RED FIRE** System with classification **B-s1, d0**, is certified by **AENOR**.



Hydrant



Sprinklers

STANDARDS

ISO15874

DIN 8077

DIN 8078

EN 12845

EN 671

EN 13501

CERTIFICATION RED FIRE

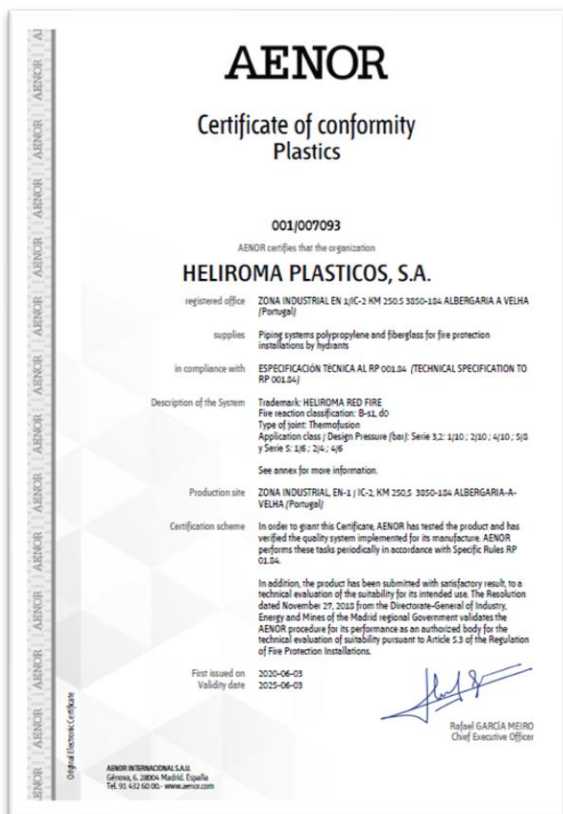

■ HYDRANTS

- The **RED FIRE** can be used as long as:
 - The **minimum simultaneity of 2 hydrants is guaranteed** for at **least 60 min**;
 - **Diameter** : Ø 25 - 45 mm
- Suitable for fire protection in installations of: **LOW RISK or MEDIUM RISK.**

Examples of buildings:

- Hospitals;
- Administrative buildings;
- Parking lots;
- Comercial centers.

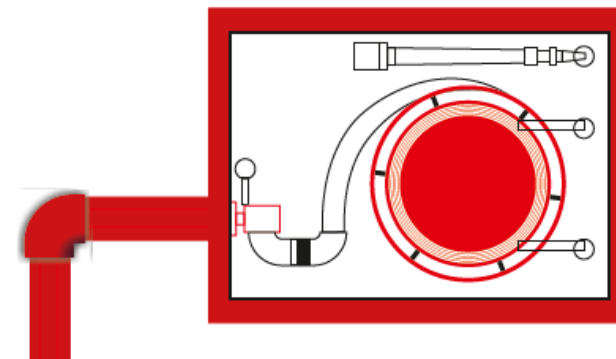

SPRINKLERS

APPLICATION:

- Wet Systems;
- Branched Systems.

Suitable for fire protection in installations of:
SLIGHT RISK; COMMON RISK. (EN 12845)

RISK LEVELS:

- **Slight Risk (LR)** – activities with low fire load, combustibility.
- **Common Risk (CR)** – activities with medium fire load and combustibility.
 (4 subgroups: CR 1 to CR 4)
- **Extra Process Risk (EPR)** – activities with high fire load and combustibility.
 (4 subgroups: EPR 1 to EPR 4)
- **Extra Storage Risk (ESR)** – activities which are not included in previous groups
 (4 subgroups: ESR 1 to ESR 2)



| | | | |
|------------|------|-------------------------------------|-------------------------------------|
| LR | LR | <input checked="" type="checkbox"/> | <input type="checkbox"/> |
| CR | CR1 | <input checked="" type="checkbox"/> | <input type="checkbox"/> |
| | CR2 | <input checked="" type="checkbox"/> | <input type="checkbox"/> |
| | CR3 | <input checked="" type="checkbox"/> | <input type="checkbox"/> |
| | CR4 | <input checked="" type="checkbox"/> | <input type="checkbox"/> |
| EPR | EPR1 | <input type="checkbox"/> | <input checked="" type="checkbox"/> |
| | EPR2 | <input type="checkbox"/> | <input checked="" type="checkbox"/> |
| | EPR3 | <input type="checkbox"/> | <input checked="" type="checkbox"/> |
| | EPR4 | <input type="checkbox"/> | <input checked="" type="checkbox"/> |
| ESR | ESR1 | <input type="checkbox"/> | <input checked="" type="checkbox"/> |
| | ESR2 | <input type="checkbox"/> | <input checked="" type="checkbox"/> |
| | ESR3 | <input type="checkbox"/> | <input checked="" type="checkbox"/> |
| | ESR4 | <input type="checkbox"/> | <input checked="" type="checkbox"/> |

APPLICATION PLACES
RED FIRE

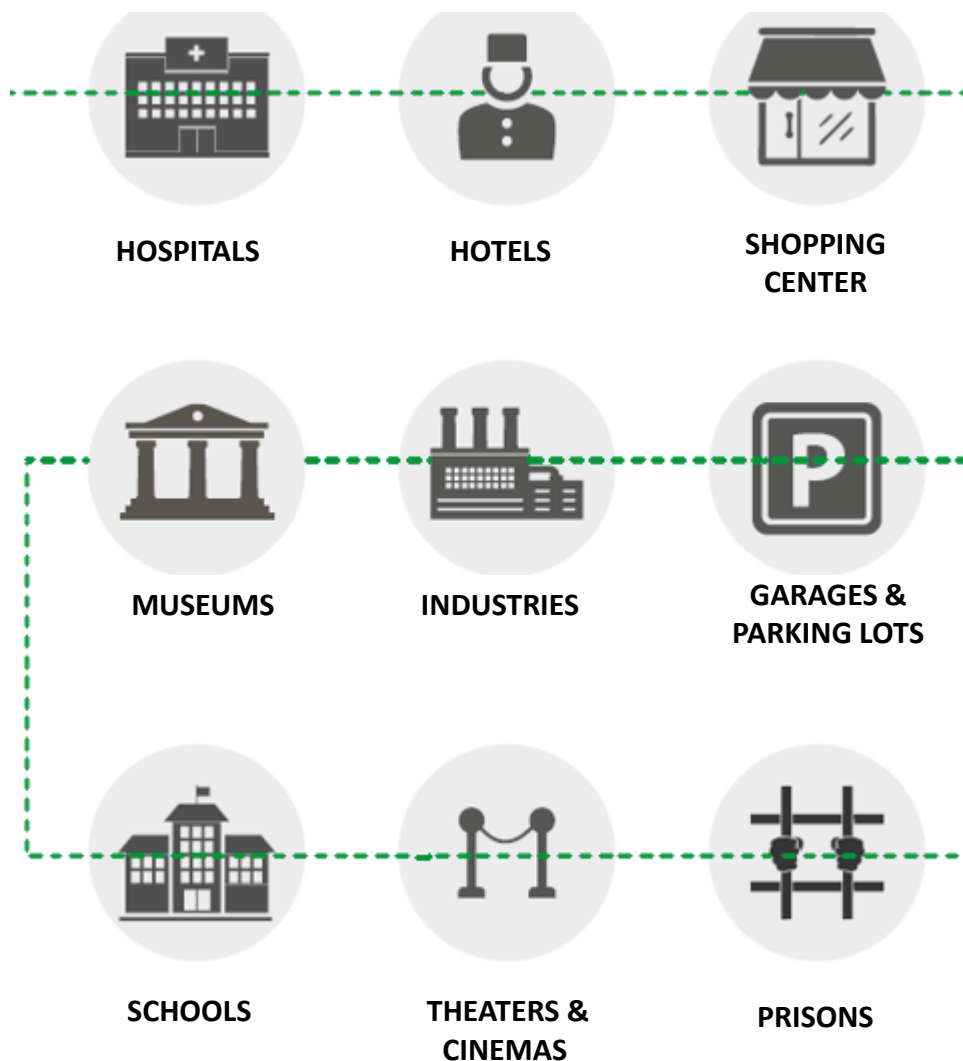

APPLICATION EXAMPLES

RED FIRE

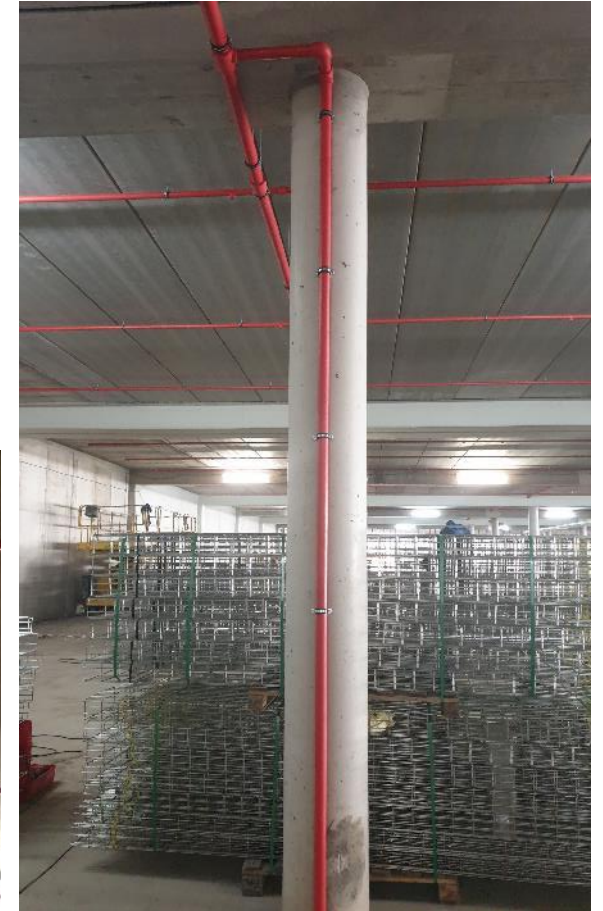

PRODUCT CHARACTERISTICS AND BENEFITS

RED FIRE



FIRE RESISTANCE B-s1,d0



THERMOFUSION SOCKET UNION



CORROSION AND CHEMICAL RESISTANCE



QUICK ASSEMBLY



PREVENTS *SPRINKLERS* CLOGGING



HIGH VERSATILITY



LOAD LOSSES REDUCTION



LIGHT WEIGHT

PRODUCT CHARACTERISTICS AND BENEFITS

RED FIRE



FIBER GLASS LAYER



LOWER THERMAL EXPANSION



REDUCED MAINTENANCE



DURABILITY



SUSTAINABLE, ECOLOGICAL



RECYCLABLE



LOWER INSTALLATION & MAINTAINANCE COSTS



CERTIFICATIONS

RED FIRE

KEY FEATURES

RELIABILITY

VERSATILITY

CERTIFICATION

LOWER TOTAL COST



HANDLING & TRANSPORTATION

RED FIRE



HOW TO TRANSPORT / HOW NOT TO TRANSPORT

HOW TO HANDLE / DO NOT HANDLE



■ INSTALLATION

RED FIRE

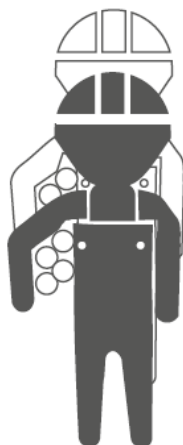

HOW TO HANDLE THE PRODUCT ON UNLOADING



HOW TO STORE THE PRODUCT AT THE UNLOADING PLACE - STORAGE



HELIROMA

Cátia Alves
técnico@heliroma.pt



www.heliroma.pt